

Design for Health

Case Study: On-the-Ground
Views, King County, Washington

September 14th, 2007

Health and Planning

- Comprehensive Planning
- Health Impact Assessment
- Climate Planning

Overview of King County

Size



Jurisdictions



Population

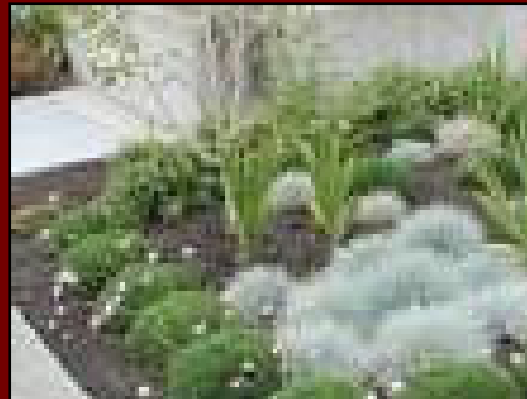

mostly how growth is accommodated...

shops



the road



homes



schools?
jobs?
parks?



Planning

- In the Seattle-King County region the Puget Sound Regional Council estimates,

... "by 2040 we can expect 1.7 million more people and 1.2 million more jobs in our four-county region. "



How Do We Change?

"The Plan"...

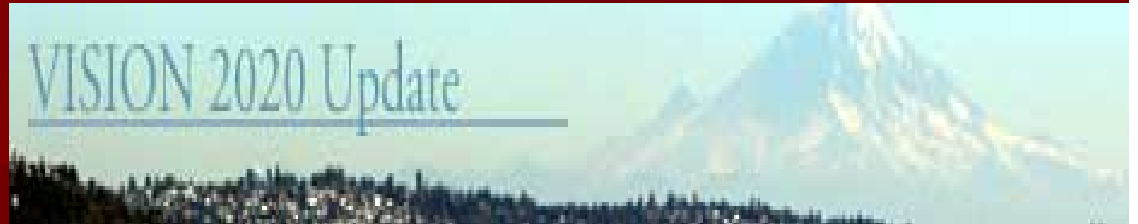

Land Use and Health

- *"Goal: ... will be places **planned and designed to promote physical, social and mental well-being** so that all people can live healthier and more active lives."*
- *"MPP-DP-40 ... to ensure that joint and mixed use developments are designed to **promote and improve physical, mental and social health and reduce the impacts of climate change on the natural and built environments.**"*

2008 King County Comprehensive Plan Major Update



- *“Review and update policies to support local food production as a means of achieving local economic health, improved public health through access to locally produced foods, and sustainable agriculture”*
- *“Review and update policies related to greenhouse gas emissions to protect public health.”*

Comprehensive Plan Update

Of nine topics, four major areas affect public health:

Chapter 2—"Urban Communities"

Chapter 3—"Rural and Nat. Resource Lands"

Chapter 4—"Environment"

Chapter 6—"Transportation"

The good, the bad, the ugly...

Chapter 2—"Urban Communities"

- Prior work (+)
- Involvement (+)



The good, the bad, the ugly...

Chapter 3—"Rural and Nat. Resource Lands"

- Ag policies (+/-)
- Rural comm's. (+/-)



The good, the bad, the ugly...

Chapter 4 — "Environment"

- Natural fit (+)
- Air qual./climate (+)



The good, the bad, the ugly...

Chapter 6— "Transportation"

- Navigating the DOT perspective (+/-)



On Change--"I'm all for it...unless it means change..."

- History
- Rearrangement
- Leading



Metropolitan King County Council

Julia Patterson

Councilmember District 5
julia.patterson@metrokc.gov



[Council Home](#) | [Councilmembers](#) | [Council News](#) | [Legisearch](#) | [County Code](#) | [KCTV](#)

PRESS RELEASE May 7, 2007

“Patterson amendments to Parks Levy aim to eliminate health disparities...Amendment connects County land use policies to improving the health of County residents”



An Opportunity



One of six health-based “Findings” in Ordinance:

“Among the attributes of parks, trails open space and recreation that lead to positive health impacts are exposure to low noise levels, clean air, clean water, increased social interactions...”

From “Expenditures” Section of Ordinance:

“...all levy proceeds shall be used as follows....for acquisition and development of rights of way for regional trails, **with primary consideration given to those projects that address health disparities/health inequities** as recognized in the Health of King County 2006 report and are consistent with the Regional Trails Plan...”

Health Impact Assessment (HIA)

“Collection of procedures by which projects, plans, and policies can be evaluated based on their potential effects on the health of a population.”

World Health Organization, Gothenberg Consensus Paper, 1999

NEED for HIA

- Enabling legislation for Environmental Impact Statements included health...
- Research and data on built environments, social environments, food environments

Actual Causes of Death, U.S., 2000

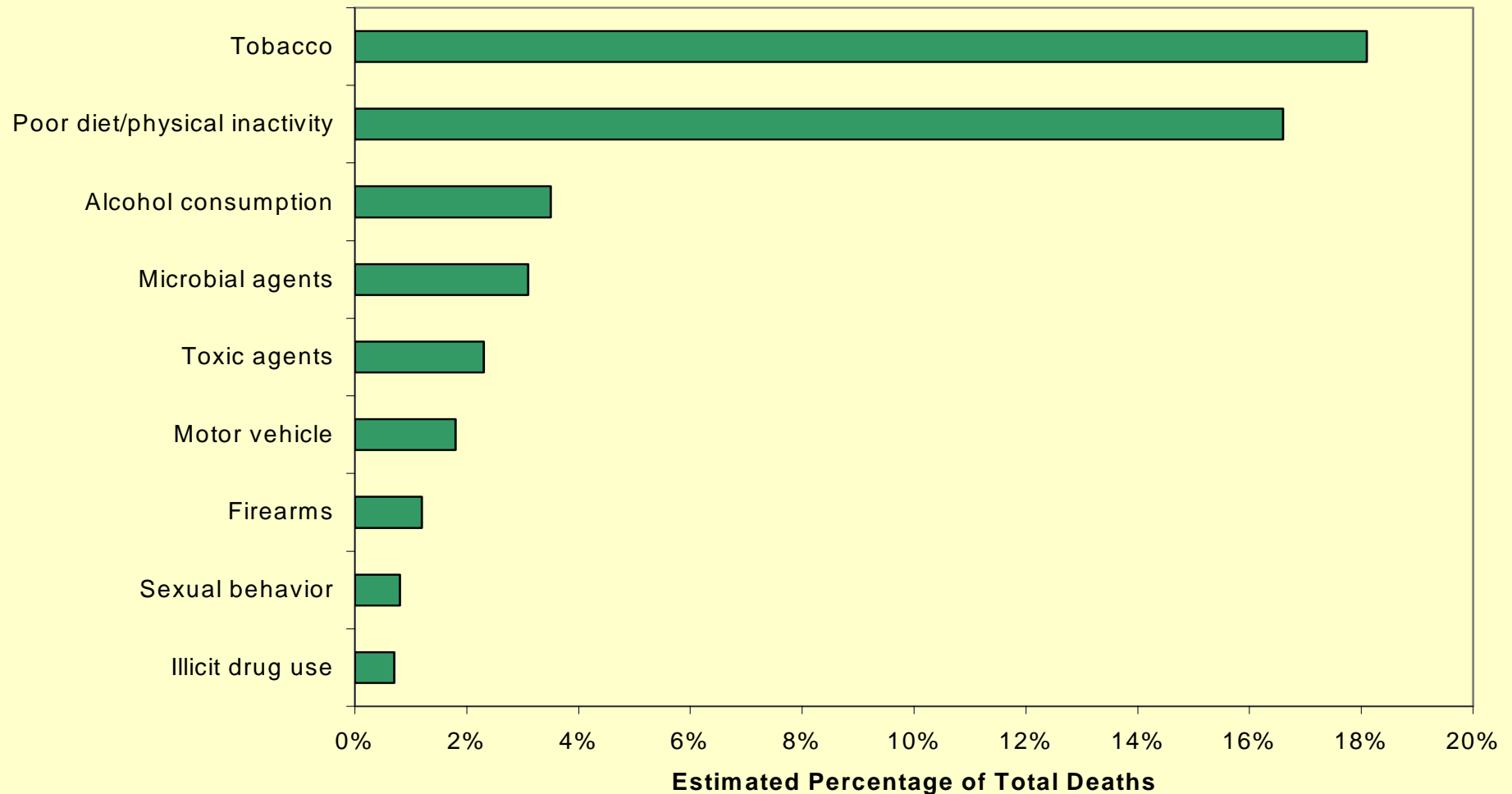

From Mokdad AH, Marks JS, Stroup DF, Gerberding JL. 2004. Actual Causes of Death in the United States, 2000. JAMA, Vol 291, No. 10 (1238-1245).
Totals do not add to 100% because list is not exhaustive.

Beacon Hill Health Indicators

Rate per 100,000 [95% CI]

| <i>Indicator</i> | <i>King County</i> | <i>Seattle</i> | <i>Beacon Hill/ SE Seattle</i> |
|--------------------------------------|--------------------------------|------------------------------|--------------------------------|
| General health fair or poor | 10.2 [8.8, 13.2] | 10.5 [10, 12.5] | 18.8 [13.7, 25.3] |
| Overweight | 52.3 [51.1, 53.5] | 45.4 [43.3, 47.5] | 56.4 [48.2, 64.3] |
| No physical activity | 13.8 [13.1, 14.7] | 10.7 [9.5, 12.1] | 21 [15.7, 27.5] |
| Motor vehicle accident deaths | 7.9 [7.2, 8.7] | 6.4 [5.3, 7.7] | 10.7 [5.5, 18.9] |
| Childhood asthma | 166.1 [158.8, 173.6] | 274.5 [254.2, 296] | 383.9 [331, 443.1] |
| Adult Asthma | 59 [56.7, 61.4] | 63.7 [59.6, 68.1] | 111.5 [95.4, 129.7] |



COMMUNITY CONVERSATIONS....



We learned...

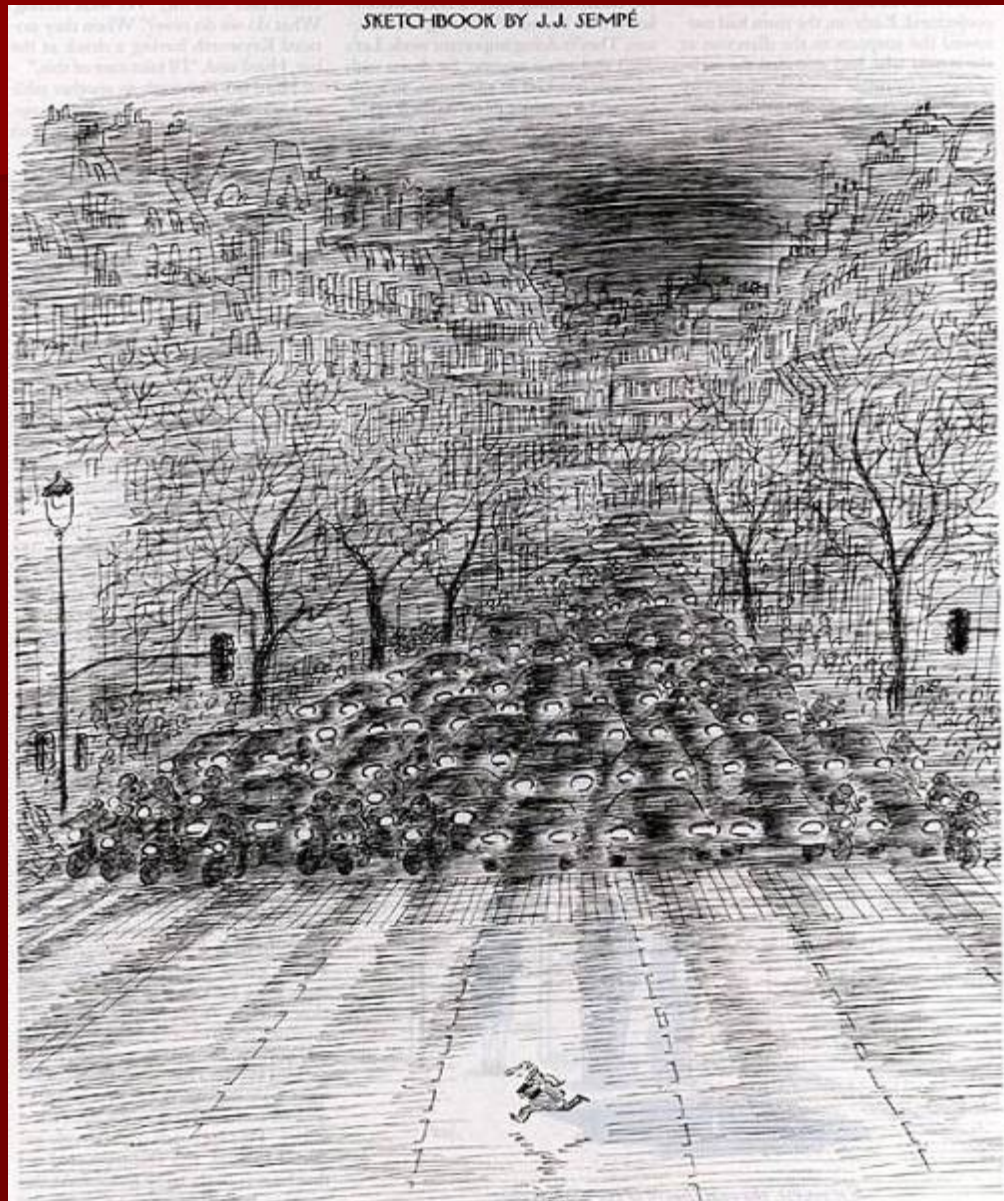

A CHARETTE— What Can We Do Differently?

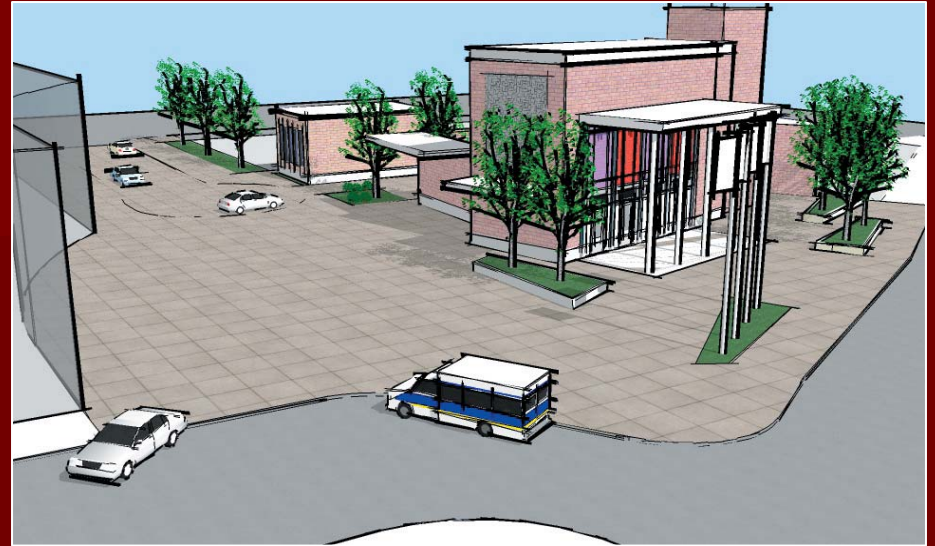

- **Community Driven**

Convened all major agencies

More than a street...

From neighborhood scale to larger scale— the health and climate connection



Climate and Health Links

- extreme weather
- temperature
- zoonotic diseases
- water and food-borne diseases
- equity
- food

Climate Change

Four Executive Orders on Climate Change issued by King County Executive Ron Sims

- 1) Land Use
- 2) Environmental Mgmt.
- 3) Renewable Energy
- 4) Transportation
- 5) Public Health?



Executive Sims is pictured signing a series of Executive Orders directing county departments to make significant operational changes to prepare the region for the growing threat posed by global warming.

The Beginning

- Executive Climate Team
- How it Worked Out



Get Involved in Climate Planning

- Realize the two aspects of climate planning
- Key strategy—who generates the most GHG emissions?



Climate Thinking

- Planning a well?
- Big stuff—infrastructure and facilities?
- What will global warming impacts render obsolete or useless in your region?



Global Warming Potential for Each Item

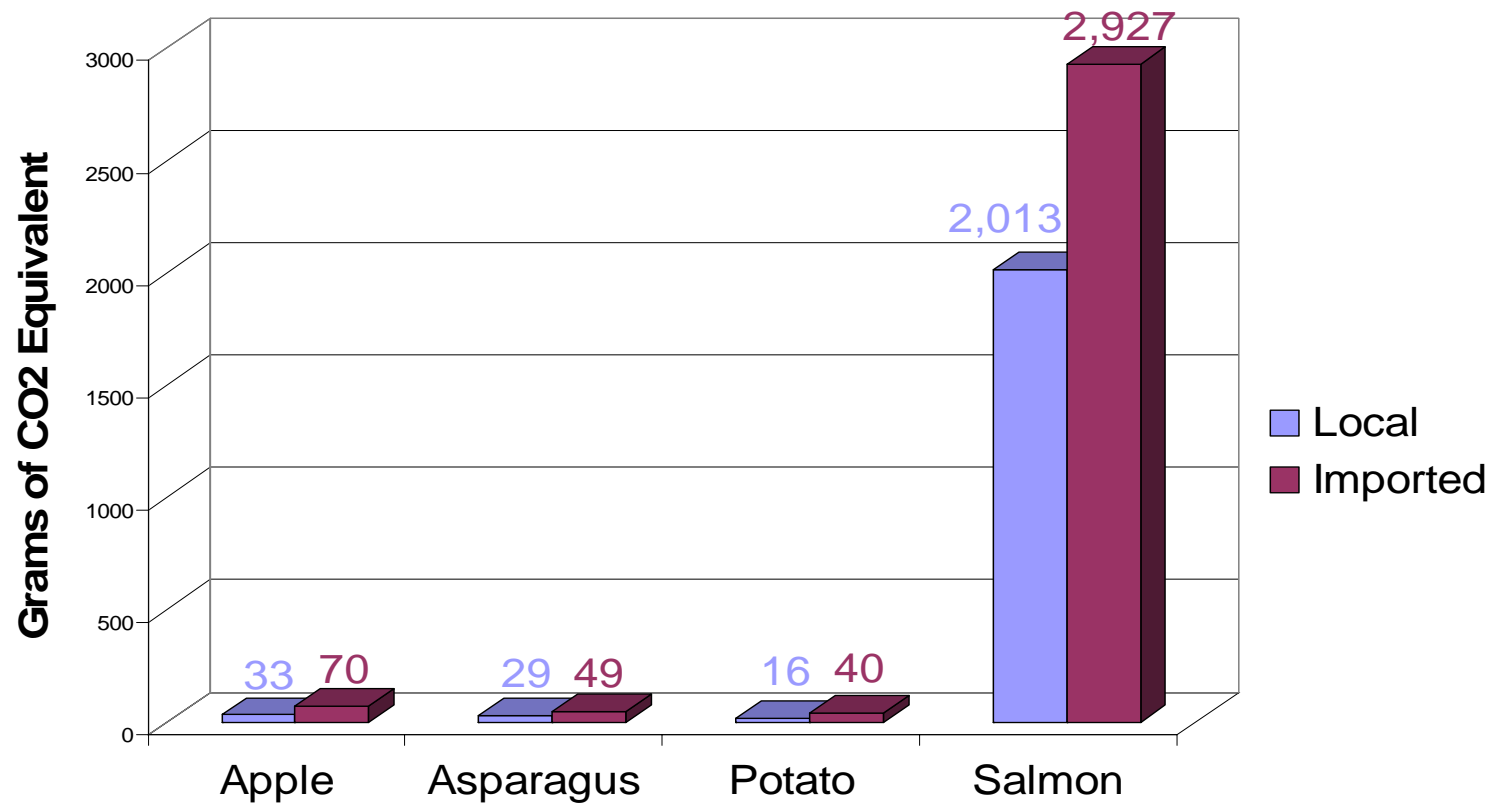

Climate Planning, Consider Food...

- Really a “bitter pill”?



- Could we get cleaner air, cleaner water, cleaner soil and better health for people and the environment?

Implementing Policies and Planning for On-the-Ground Change

- Know your allies
- Work together
- Politics and controversy
- Accept reality

Anne Biklé, MLA
Environmental Planner

Built Environment
& Land Use Program

Seattle-King County Public Health
anne.bikle@kingcounty.gov
206-263-8446

